

- TREE PLANTING TO BS 3936**
- CA 3 x Corylus avellana (Common Hazel)
 - AC 2 x Acer campestre (Field Maple)
 - QR 1 x Quercus robur (English Oak)
- HEDGE PLANTING**
- 70% Hawthorne
 - 10% Blackthorn
 - 10% Hazel
 - 10% Rowan
- Planting to be staggered and to comprise 2 rows, approx 30cm apart, with approx 40cm between each plant. Proposed height of 450 - 600mm

SITE PREPARATION

The planting areas shall be cleared of weeds, particularly large perennial weeds that could be in competition with the establishment of new stock. Planting areas to be treated with herbicide prior to the planting preparations. The planting areas should be cultivated to provide sufficient depth of free draining soil to ensure adequate early establishment of stock.

Existing parking spaces = 15

Proposed parking spaces = 29 (incl. 3 no. disabled spaces)

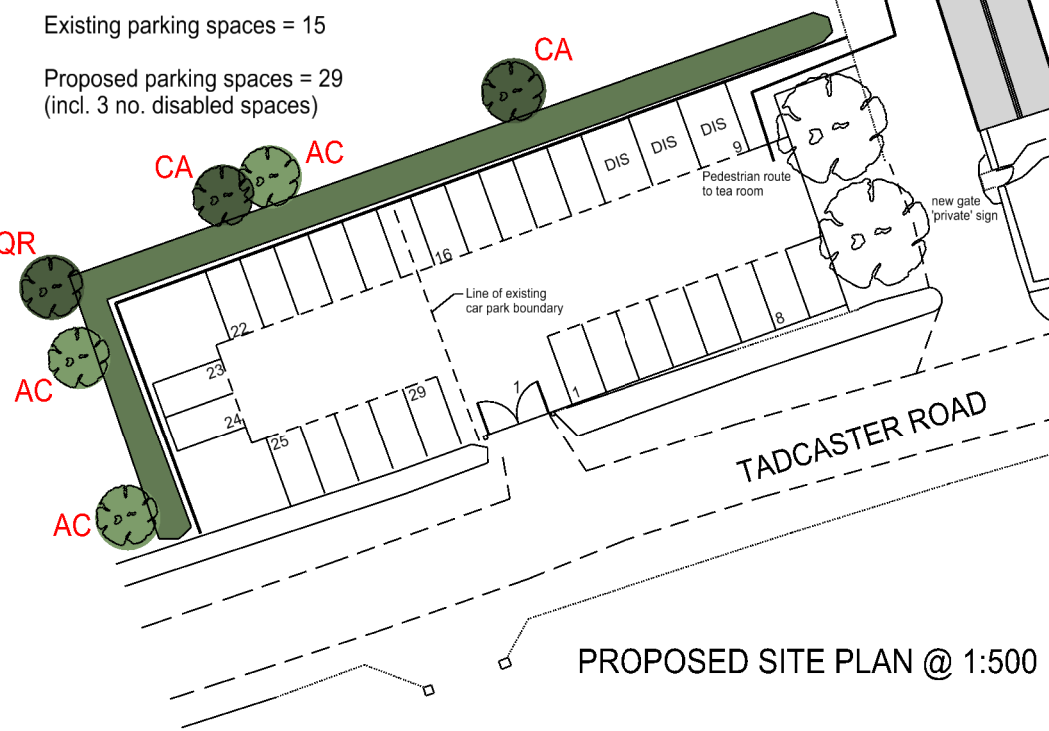

PROPOSED SITE PLAN @ 1:500

AMENDED DRAWING

PLANTING

All planting operations will be carried out in suitable weather conditions between October and March, unless otherwise agreed, November being the optimum time for planting. Planting areas will be prepared to accommodate the roots of the stock and allow planting to the original depth. New plants will be made firm to avoid movement, which could significantly increase the chance of failures. Firmness of stock will be checked after the first few weeks, particularly if heavy frosts follow the planting. Compost (peat free) will be added to the planting to improve soil consistency and fertility levels to help establish the stock. Tree protection shall be used to reduce losses, particularly if rabbits or deer are present in the area. Supportive stakes fixed to the windward side of the trees, these shall be secured by non-abrasive ties that allow the trees to move. Watering shall take place after planting to settle the soil around the root system and ensure that the plants become established, particularly if the planting operation takes place late in the planting season.

MAINTENANCE

Maintenance operations shall be carried out by suitably experienced persons. Weed growth shall be controlled until stock is well established. Any dead and / or damaged plant material will be replaced after the first season. Any damaged tree tubes / stakes will be replaced until the new stock is established, usually four to five years. Tree ties will be checked regularly to ensure that they are not restricting growth.



LISTINGS

The farmyard complex of North House Farm was first recognised in August 1980 when it was designated as part of the Bolton Percy Conservation Area. The main farmhouse, North House is one of ten listed buildings in the village of Bolton Percy and was Grade II listed on the 9th April 1987, with the English Heritage Building ID of 326408, Bolton Percy, Tadcaster Road, SE 54 SW (north side) 4 / 24 North House.

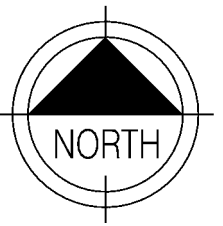

JB : Architectural to be notified of any discrepancies. Contractors must check all dimensions on site. This drawing is copyright and is for use on this project only. This drawing is to be used solely for the information as titled. For other information refer to the latest revision of any cross referenced drawings.

rev	date	description
A	29.01.2020	Landscape details added

STATUS **PLANNING**

CLIENT **MR & MRS H HOUSEMAN**

PROJECT **NORTH HOUSE BOLTON PERCY YORK YO23 7AN**

DRAWING TITLE **PROPOSED SITE PLAN**

job no. 5320	drawing no. P 05	revision A
date Nov 19	scale 1:500	sheet A3

JB : Architectural

REGISTERED PRACTICE

T: +44 (0)7884 232935
E: info@jbarchitectural.co.uk
www.jbarchitectural.co.uk